

# ALPHA

8478UOO200P63

EAN 4031582313420

Fixed castor, Fork made of Stainless Steel, wheel axle with nut, plate fitting.

Wheel centre made of Polyamide, plain bearing



BETTER MOBILITY. BETTER LIFE.



Picture may differ from original product

## Technical Data

|                        |                |
|------------------------|----------------|
| Wheel diameter         | 200 mm         |
| Width of Tread         | 50 mm          |
| Castor width           | 115 mm         |
| Size of Plate          | 140 x 115 mm   |
| Plate hole centres     | 105 x 80/75 mm |
| Plate hole             | 11 mm          |
| Overall height         | 240 mm         |
| Temperature            | - 40 / + 80 °C |
| Standard               | EN 12532       |
| Weight                 | 1.63 kg        |
| Hardness of tread      | Shore D 75     |
| Load capacity          | 500 kg         |
| Load capacity (static) | 1000 kg        |

## Advantages at a glance

|                      |           |
|----------------------|-----------|
| Roll performance     | ● ● ● ○ ○ |
| Movement noise       | ● ● ● ○ ○ |
| Attrition            | ● ● ● ● ● |
| Corrosion resistance | ● ● ● ● ● |

## Dimensions

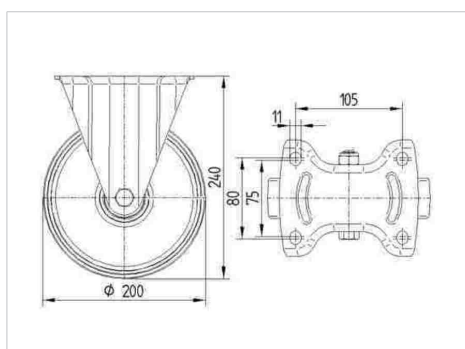

## Structure & Mounting

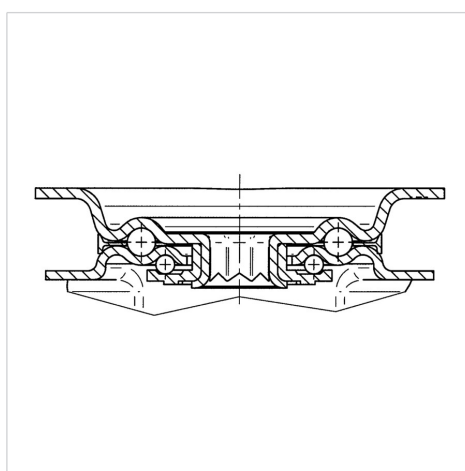

# ALPHA

8478UOO200P63

EAN 4031582313420



BETTER MOBILITY. BETTER LIFE.

## Structure & Mounting

---

