

# ALPHA

8470BOG100P62

EAN 4031582346688

Swivel castor, Housing made of Stainless Steel, double ball bearing swivel head, wheel axle with nut, plate fitting. Wheel made of heat resisting synthetic material, self-lubricating bushing



BETTER MOBILITY. BETTER LIFE.



Picture may differ from original product

## Technical Data

Wheel diameter	100 mm
Width of Tread	35 mm
Castor width	79 mm
Size of Plate	105 x 85 mm
Plate hole centres	80/77 x 60 mm
Plate hole	9 mm
Dome-Ø	75 mm
Offset	41 mm
Swivel Interference	182 mm
Overall height	128 mm
Temperature	- 40 / + 250 °C
Standard	EN 12532
Weight	0.793 kg
Swivel Radius	91 mm
Hardness of tread	Shore D 90
Load capacity	125 kg
Load capacity (static)	250 kg

## Advantages at a glance

Roll performance	● ● ● ● ○
Movement noise	● ● ● ○ ○
Attrition	● ● ● ● ●
Corrosion resistance	● ● ● ● ●

## Dimensions

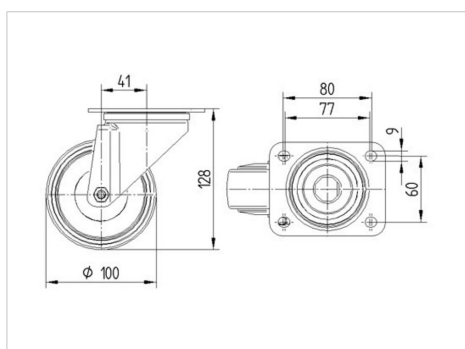

## Structure & Mounting

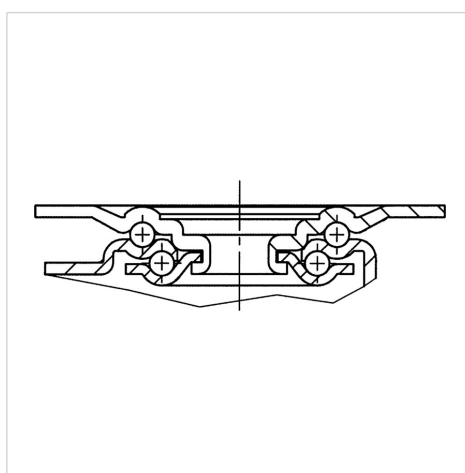

# ALPHA

8470BOG100P62

EAN 4031582346688



BETTER MOBILITY. BETTER LIFE.

## Structure & Mounting

